

Mary Hews

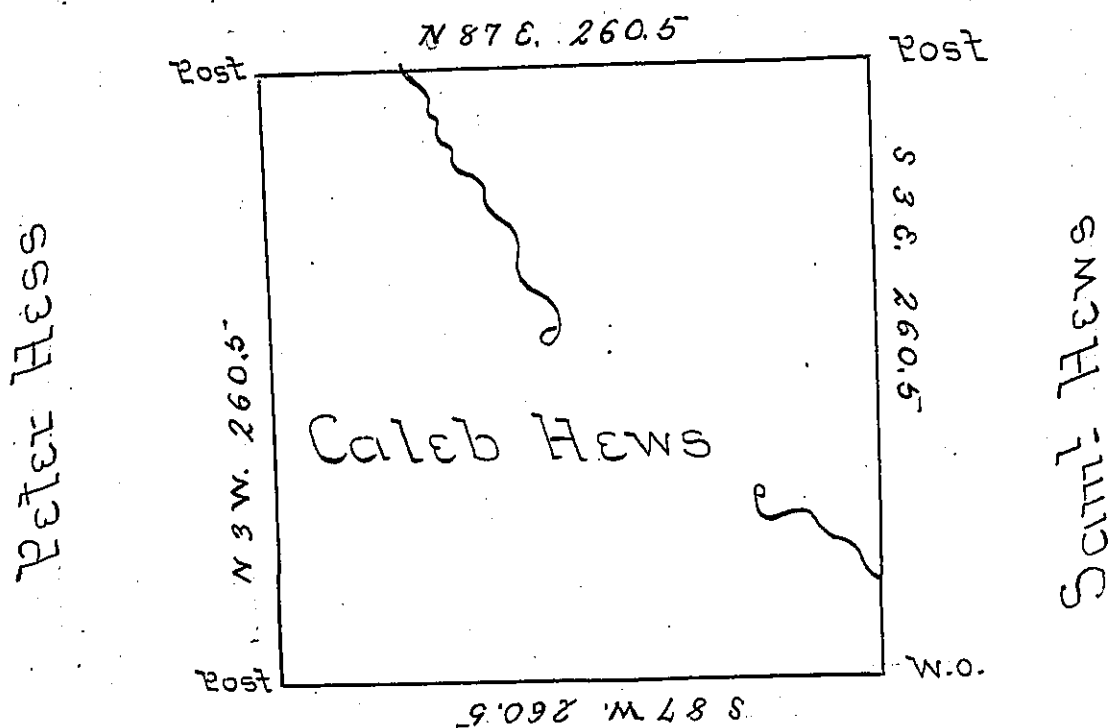

Peter Heyle

Situate on the Waters of Beaver Creek in district
 No 3 Allegany County containing 400^{as} 16^{ps} and
 Allowance Survey'd the 27-May 1795 in pursuan-
 ce of a Warrant granted Caleb Hews 21-April
 1704. —

Ben. Stokely D.S.

Wm. Brodhead Esq. Sg.

New Mercer County —

IN TESTIMONY that the above is a copy of the original remaining on file in
 the Department of Internal Affairs of Pennsylvania, made
 conformably to an Act of Assembly approved the 16th day of
 February, 1833, I have hereunto set my Hand and caused
 the Seal of said Department to be affixed at Harrisburg,
 this Twenty eighth day of February 1905.

James R. Brown
 Secretary of Internal Affairs